

Congratulations on your new DC SUPER FLEX

To get the most satisfaction from your cutter, it is important that you spend two minutes learning how to operate and maintain it.

Use an in-/external compressed air aftercooler.
Maximum water content per m³ supply air:
20g/m³, (0,7 ounce/35 cfm)

 Air requirement
650 l/min, (22 cfm)

 Air pressure
10 bar - 145 psi

 Power Supply
110/220 V ac

For more information, read the attached user manual.

Forcing a 90° bend

- Turn the cutter in the same direction as the bend.
- Raise the cutter arm.
- Push the cutter through.
- Lower the cutter arm.
- In the case of several bends, make a note and put tape on the hose, so you know which way it shall face.

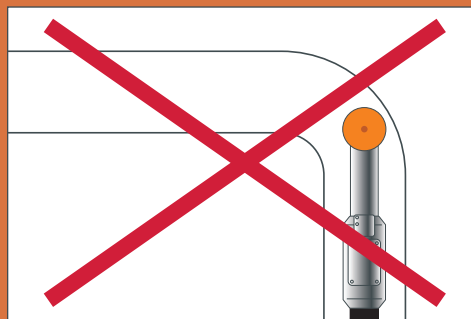
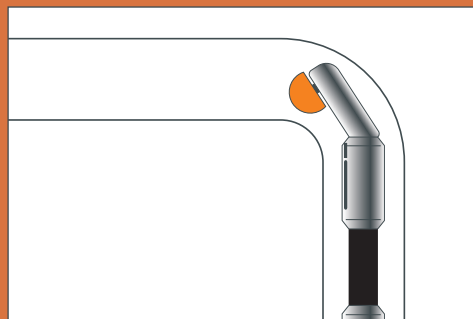

As needed

- Lubricate the drum shaft with grease in the grease nipple.
- Check the air filter (part number P57106) in the water separator to be kept clean and changed as needed.

Grease in the grease nipple

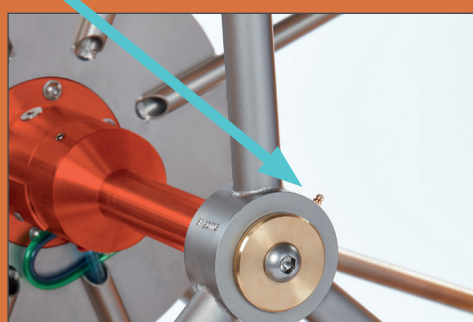

Air filter

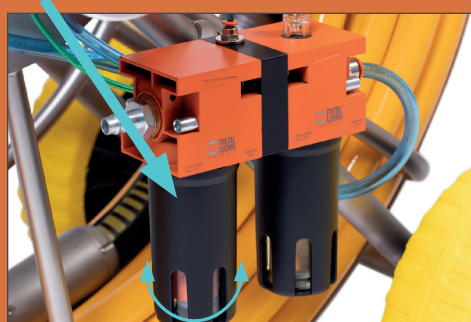

Before use

- Check that there is oil in the lubricating unit.
- **NEVER** bend the cutter outside of the pipe.
- The cutter operator is responsible for ensuring that the cutter is handled safely, in and outside the pipe.
- The forward section must **ALWAYS** be closed together during transport in and outside the pipe.
- Only use **PURE AIR - WASHER FLUID W/ALCOHOL** in the container for camera cleaning.

Check the oil



Completely close the forward/back drive



After use

- Clean the outside of the cutter with a water hose (not a high-pressure cleaner) or compressed air.
- Clean the forward/back drive with compressed air. Fully extend the unit and clean it in traces and edges with paper and cloth. (possibly with a small screwdriver in the tracks).
- Raise the arm all the way and clean the hollow space behind the tilt unit using compressed air. Next, lubricate the piston with oil and re-lower the arm.
- Unscrew the Unbrako screw in the end of the air motor (GRS), fill the screw hole with blue grease and then re-attach.

The screw hole for grease (GRS)



Lubricate the piston

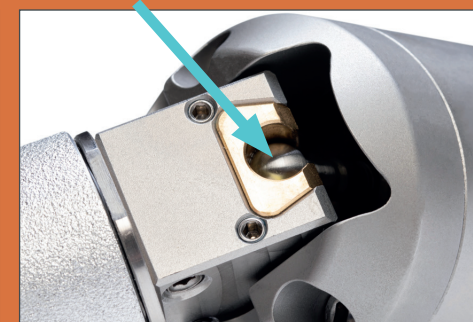

Information

Technical support

If you experience problems with the cutter or if you have any technical questions, please write to support@dancutter.dk

Order

If you need spare parts or cutting heads, please write to order@dancutter.dk



 **DANCUTTER**

dancutter.com

**Use an in-/external
compressed air
aftercooler.**

**Maximum water
content per m³
supply air: 20g/m³,
(0,7 ounce/35 cfm)**